

BallPark Accommodation Guide

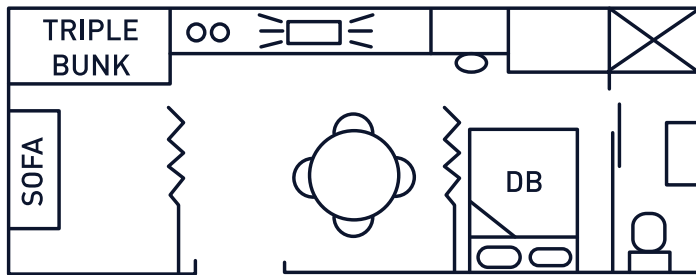

STANDARD UNIT

- Double bed
- Triple bunk
- Sofa
- Ensuite
- Kitchen
- Remote colour TV
- Ceiling fan
- Reverse cycle air conditioning

OFF PEAK COSTS

Two Person	\$70
Extra Adult	\$15
Extra Child	\$6

PEAK COSTS

Two Person	\$100
Extra Adult	\$15
Extra Child	\$6

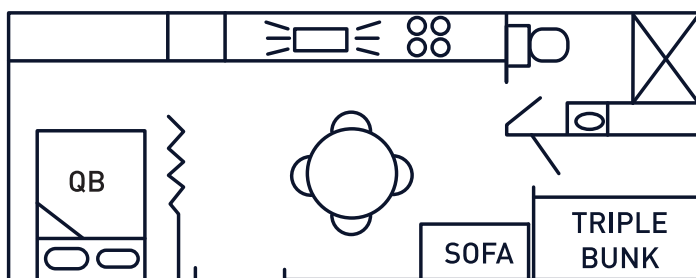

DELUXE UNIT

- Queen bed
- Triple bunk
- Sofa
- Ensuite
- Kitchen
- Remote colour TV
- Reverse cycle air conditioning

OFF PEAK COSTS

Two Person	\$80
Extra Adult	\$15
Extra Child	\$6

PEAK COSTS

Two Person	\$105
Extra Person	\$15
Extra Child	\$6

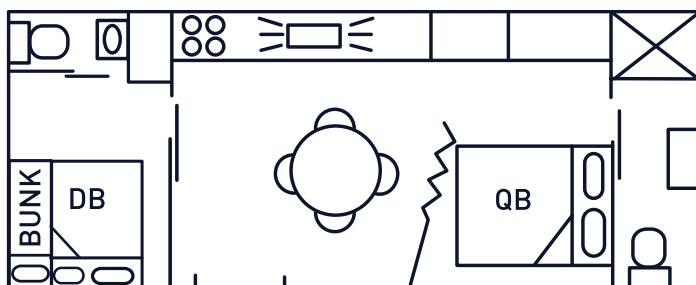

DELUXE DOUBLE UNIT

- Queen bed
- Double bed with single bunk
- Sofa
- Ensuite
- Kitchen
- Remote colour TV
- Reverse cycle air conditioning

OFF PEAK COSTS

Two Person	\$80
Extra Adult	\$15
Extra Child	\$6

PEAK COSTS

Two Person	\$105
Extra Adult	\$15
Extra Child	\$6

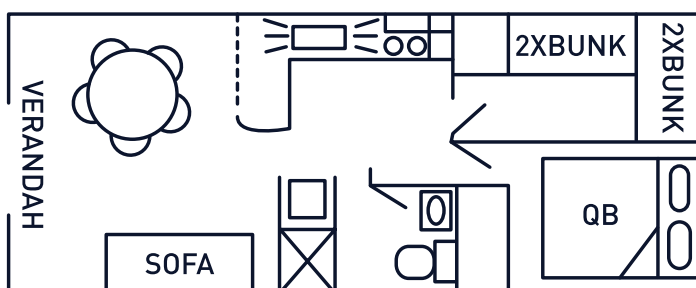

EXECUTIVE UNIT

- Queen bed
- Built-in Robes
- 2 x double bunks
- Sofa
- Ensuite
- Kitchen
- Microwave
- Remote colour TV
- Reverse cycle air conditioning

OFF PEAK COSTS

Two Person	\$90
Extra Person	\$15
Extra Child	\$6

PEAK COSTS

Two Person	\$115
Extra Person	\$15
Extra Child	\$6

Enjoy your holiday on the majestic Murray River

BallPark Accommodation Guide

POWERED SITE OFF PEAK COSTS



Two Person	\$28
Extra Adult	\$10
Extra Child	\$6

PEAK COSTS

Two Person	\$35
Extra Adult	\$10
Extra Child	\$6

ENSUITE SITE OFF PEAK COSTS



Two Person	\$35
------------	------

PEAK COSTS

Two Person	\$40
------------	------

UNPOWERED SITE OFF PEAK COSTS



Two Person	\$20
Extra Person	\$10
Extra Child	\$6

PEAK COSTS

Two Person	\$22
Extra Person	\$10
Extra Child	\$6

EXTRA COSTS

Extra car/boat	\$5
Extra car/boat - p/w	\$15
Cot hire	\$10
Linen hire per bed	\$15

ADULTS CHILD

16+
3 to 15

Peak Season

- 25TH DECEMBER TO 31ST JANUARY
- EASTER THURSDAY FOR 1 WEEK
- LONG WEEKENDS IN MARCH, JUNE & NOVEMBER

Our park is set on the banks of the Murray River, beside the historic John Foord Bridge. Ball Park adjoins the town pool, tennis courts, bowling greens and is only a minutes walk to the town centre of Corowa and Wahgunyah and a short drive to the licensed clubs, 27 hole golf course and the renown Rutherglen Wineries.

Ball Park is part of the friendly 'Family Parks' group.

Caravan Park Facilities

- Modern playground and jumping pillow
- 3 large undercover BBQ areas with seating for up to 32 people in each
- Kiosk sells newspapers, ice, gas, groceries etc.
- Boat ramp
- Laundry facilities
- Disabled facilities
- Adjacent to Olympic swimming pool - open November to March 31st
- Camp fires permitted, subject to fire bans
- Dogs are permitted; excluding Christmas and Easter

Park Unit Facilities

- Blanket, sheets pillows and towels are not provided but are available for hire
- Check in time is 2.00pm on arrival day
- Check out time is 10.00am on departure day
- Late check outs can sometimes be arranged
- All prices subject to alteration without notice
- Pets are not permitted with unit bookings
- Dogs must be on leads and supervised at all times



Andrew & Sonia Palmer 02 6033 1426 02 6033 4282

Bridge Road Corowa NSW 2646 ballpark@bigpond.net.au www.ballparkcaravanpark.com.au